



Specifications

Electrical Ratings	2A @ 36VDC 1A @ 125VAC 0.5A @ 250VAC	Actuation Travel	16mm - 1.6 ± .25mm 19mm - 2.0 ± .25mm
Electrical Life	50,000 cycles typical	Dielectric Strength	2000Vrms min contact to contact
Contact Resistance	<50mΩ initial	Insulation Resistance	>100MΩ min
Actuation Force	16mm - 500 ± 100gF 19mm - 750 ± 100gF	Sealing	IP65
		Operating Temperature	-25°C to 55°C
		Storage Temperature	-25°C to 55°C

Materials

Actuator	Stainless Steel, Brass (Nickel or Gold Plated)
Threaded Body	Stainless Steel, Brass (Nickel or Gold Plated)
Nut	Stainless Steel, Brass (Nickel or Gold Plated)
Terminal Support	Polybutylene Terephthalate (PBT)
Contacts	Silvery Alloy
Terminals	Brass, Nickel Plated

Ordering Information

1. Series	BH	16	N	R	S	Z	X
BH							
2. Switch Body Diameter							
16 = 16mm							
19 = 19mm							
3. Switch Function							
N = Momentary							
4. Actuator Style							
M = Round							
F = Flush							
R = Raised							
B = Flush, Ring Illuminated Only available in 16mm, see AH series for 19mm illuminated							
C = Flush, Dot Illuminated Only available in 16mm, see AH series for 19mm illuminated							
5. Switch Finish							
S = Brushed Stainless Steel							
N = Nickel plated brass							
P = Gold plated brass							
6. Terminal Options							
Z = Screw Terminal							
B = Solder Lugs Illuminated versions only available with solder lugs							
7. LED Color							
X = No LED	*Only available in 16mm diameter						
R = Red	RO = Red / Orange dual LED				YG = Yellow / Green dual LED		
Y = Yellow	RY = Red / Yellow dual LED				YB = Yellow / Blue dual LED		
G = Green	RG = Red / Green dual LED				GB = Green / Blue dual LED		
B = Blue	RB = Red / Blue dual LED						
W = White	OY = Orange / Yellow dual LED						
O = Orange	OG = Orange / Green dual LED						
	OB = Orange / Blue dual LED						

BH

Illuminated Pushbutton

Dimensions - 16mm

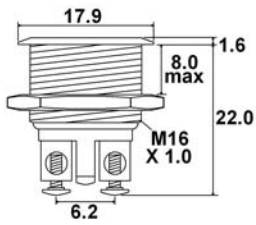
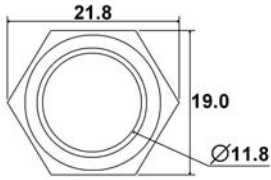

F

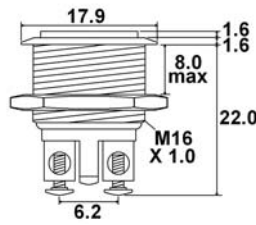
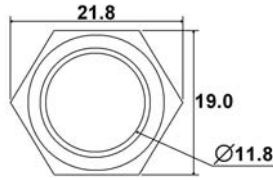

R

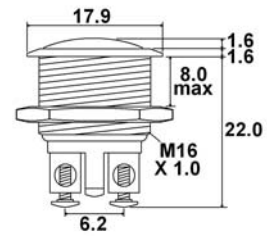
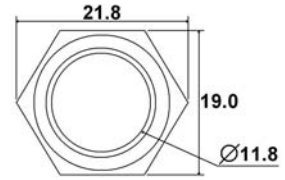

M

Dimensions - 16mm Illuminated

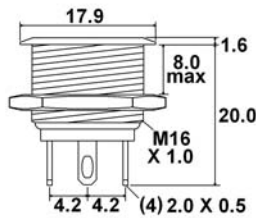
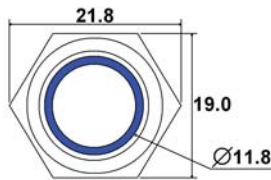

B

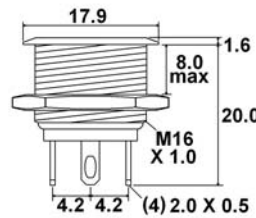
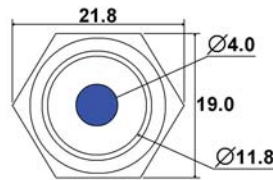

C

Dimensions - 19mm

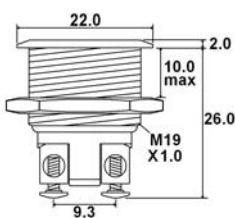
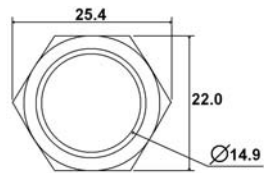

F

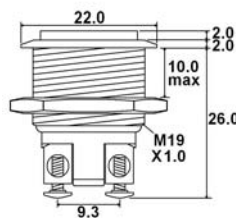
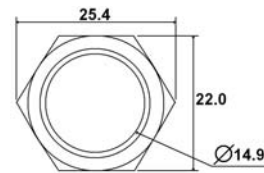

R

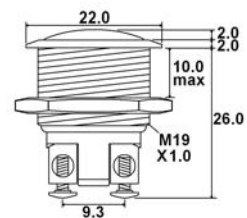
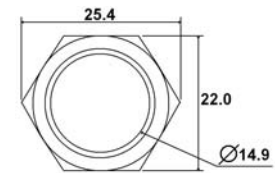

M

Dimensions shown in mm. Dimensions are shown for reference purposes only.

Specifications and availability subject to change without notice.

Terminals

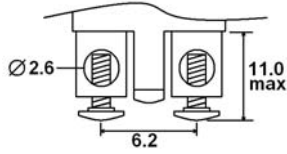

**16mm
Z Screw Terminal**

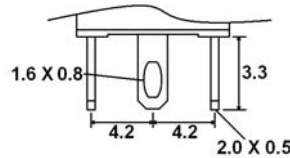

**16mm
B Solder Lug**

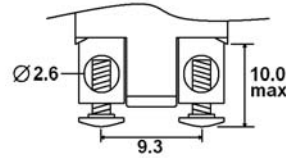

**19mm
Z Screw Terminal**

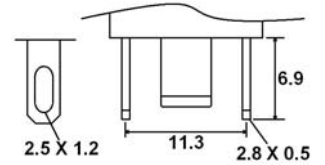

**19mm
B Solder Lug**

Schematics

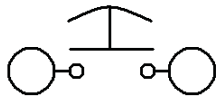

SPST

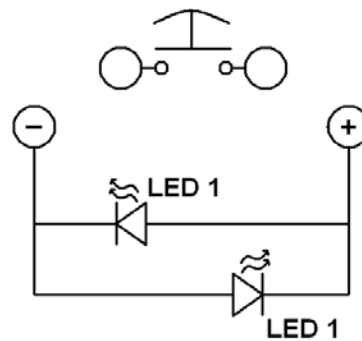

SPST with LED

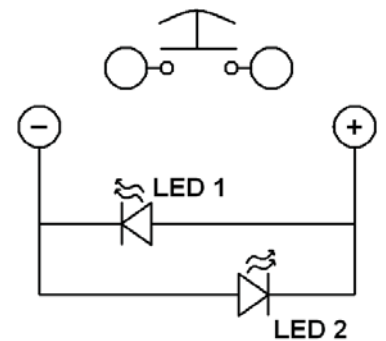

SPST with dual LED

Panel Cut-Outs

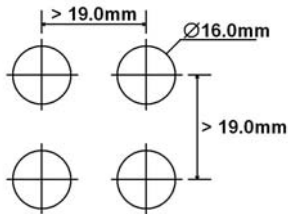

16mm

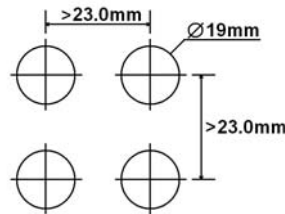

19mm

LED Characteristics

LED Ratings		Color						Units
		R	Y	G	B	O	W	
Reverse Voltage	V_R	5	5	5	5	5	5	V
Forward Current (avg)	I_F	25	25	30	30	25	30	mA
Forward Current (peak)	I_{FS}	120	120	160	160	120	160	mA
Reverse Current $V_R = 5V$	I_R	10	10	10	10	10	10	μA
Power Dissipation	P_T	80	80	120	120	80	120	mW
Operating & Storage Temperature	T_A	-25 ~ +55						$^{\circ}C$
Forward Voltage (typ) $I_F = 20mA$	V_F	2.1	2.1	3.3	3.3	2.0	3.0	V
Forward Voltage (max) $I_F = 20mA$	V_F	2.4	2.5	3.6	3.6	2.3	3.6	V
Wavelength at Peak Emmission, $I_F = 20mA$	λ_P	635	592	516	463	606	n/a	nm
Spectral Line Half-Width, $I_F = 20mA$	$\Delta\lambda$	14	12	28	20	12	n/a	nm
Luminous Intensity, $I_F = 20mA$	LI	120	120	170	100	120	700	mcd
Viewing Angle	Θ	145	145	145	145	145	145	deg